

This modular buoy GBM 2400, 2400mm in diameter, volume of 5m³, is intended for the beaconing of semi-exposed sites by offering a reinforced stability. This stability guarantees an optimal service to the users and a maximum security for the maintenance staff while on board.

The buoy is made of the following items:

- 4 quarters of float in polyethylene for 5m³ volume
- 1 steel ballast support
- 1 superstructure



GBM2400 – 5Q HVPE – Tail version

Based on the 5m³ volume float, several models are available, with superstructures in aluminium or in polyethylene and ballast support with different lengths.

The float is filled with polystyrene foam in order to guarantee the buoy buoyancy even in case of damage to the polyethylene envelope. The rotomoulded polyethylene is of medium density type, stained in the mass and is UV resistant.

The float has a non skid surface and feet stop to enhance the security on the buoy.

Two types of steel ballast supports can be supplied, depending on the site conditions: “G” type tail or “J” type skirt keel version. The tail ballast support version is equipped with a drift which improves the buoy sea keeping. All the ballast supports are protected against corrosion with an appropriated marine paint system. Two anodes are fitted to protect the ballast support and the first 5 meters length of the chain against corrosion.



GBM2400 – 5J – Skirt keel version



Buoy specifications

MODEL	2400 5J	2400 5Q	2400 5Q
	ALU	ALU	HVPE
Diameter (mm)	2400	2400	2400
Volume (m ³)	5	5	5
Reserve buoyancy (m ³)	3.2	3.1	3.3
Mass (kg)	1715	1788	1651
Ballast (kg)	Variable	780	520
Focal plane (mm)	4229	4189	3805
Draught (mm)	1957	2573	3184
Height of superstructure (mm)	3000	3000	2700



Data buoy

The superstructure can be realized in marine aluminum or in polyethylene.

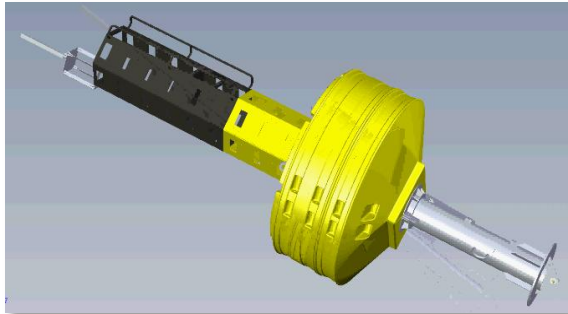

2400 – 5Q – HVALU version



2400 – classic Alu version



2400 – 5Q – HVPE version

The aluminium superstructure is protected against corrosion by a marine paint system. The finishing color is in conformance with IALA recommendations.

The rotomoulded polyethylene is of medium density type, stained in the mass and UV resistant. The colour of the polyethylene is in conformance with IALA recommendations.

The HVPE high visibility Polyethylene spar can be used as an ashore pylon.

Optional equipment

- LED self contained lantern or long range LED beacon with solar generator
- Radar reflector, RACON or AIS transponder
- Monitoring system type VEGAWEB

